

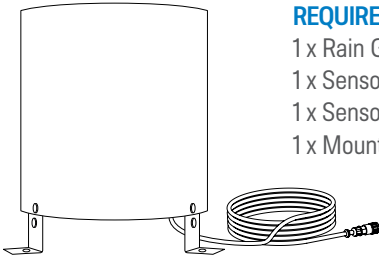

RAIN GAUGE SENSOR INSTALLATION GUIDE

farmsense.nz

INSTALLING A SENSOR HUB AND RAIN GAUGE SENSOR



REQUIRED IN THIS STEP:

- 1 x Rain Gauge Sensor
- 1 x Sensor Hub (any model)
- 1 x Sensor Hub bracket
- 1 x Mounting hardware

TOOLS REQUIRED

- 3mm drill for plastic/wood or
- 6mm drill for concrete
- Cordless drill
- Phillips screwdriver or bit
- Marker Pen
- Spirit level

NOTE: If installing a new Sensor Hub then please follow the instructions in the Sensor Hub User Guide that came with that unit to setup and pair it first.

- 1.1** Select a suitable location to mount the Rain Gauge Sensor that is:
 - Level.
 - Not sheltered by trees or other tall objects.
 - High enough above any flat surface to avoid rain splashing into the sensor.
- 1.2** Select a suitable location to mount the Sensor Hub that is:
 - North facing in direct sunlight.
 - Has line of sight to the WiFi Adapter or other Sensor Hubs, or for Sensor Hub 4G models has mobile network coverage.
 - Within cabling distance of the Rain Gauge Sensor 1.5m.
- 1.3** Prepare the Rain Gauge Sensor for installation by removing the white foam transit support block from the bottom of the Sensor and replacing it with the included cover. Do this just prior to installation.

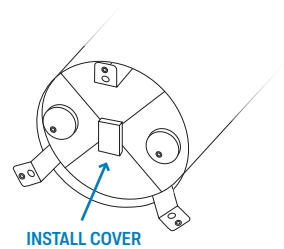

1.3

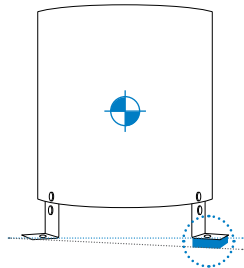

1.4

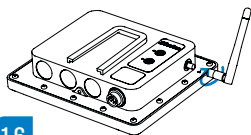

1.6

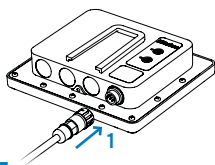

1.7

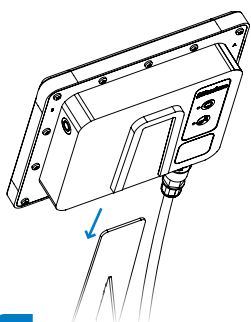

1.8



POWER



NETWORK



WIFI



4G

1.9

- 1.4 Screw the Rain Gauge Sensor down using the included screws provided in the mounting hardware kit. Make sure the sensor is level and insert packers under the feet if required.
- 1.5 Screw the Sensor Hub mounting bracket down using the screws provided in the mounting hardware kit.
- 1.6 If your Sensor Hub came with an antenna, install it now. It should be finger tight.
- 1.7 Connect the Rain Gauge Sensor to Connector 1 (or the next free connector) on the Sensor Hub, the push-lock connector will “click” when it is correctly installed. The Sensor Hub will power on and beep twice.
- 1.8 Slide Sensor Hub on to the secured mounting bracket.
- 1.9 The Network LED will indicate if the unit has successfully communicated with the WiFi Adapter or other Sensor Hubs, or for 4G models the 4G LED will indicate if the unit has successfully communicated with the mobile network. It may take up to 15 minutes for the unit synchronise to the networks. If the power LED is not on, tap the network button to wake up the LED's.

WARRANTY

All FarmSense products are warranted to be free from defects in material or workmanship for a specified period from the original date of purchase.

All our products carry a minimum 12-month manufacturer's warranty unless otherwise stated.

The terms of the warranty are that the product is fit for its intended purpose, provided it is used in a proper manner and according to the manufacturer's instructions.

In particular, the warranty does not cover non-agricultural or non-residential use.

Warranty exclusions include (but are not limited to):

- product failure outside the warranty period;
- physical mishandling, misuse, abuse or negligence;
- "acts of God" and/or "force majeure" (e.g. lightning, flood, fire, theft, etc.)
- water immersion or ingress beyond stated IP rating;
- contamination by chemicals (e.g. battery acid, etc.)
- improper power supply (e.g. incorrect voltages; surges; transients; etc.)
- attempted repair or modification by a non-authorized repair agent;
- cosmetic or surface corrosion;

- factory serial number / date-code removed or made illegible;
- damage caused by 3rd party systems or components (e.g. data network voltages, etc.);
- data loss. (Please ensure data is backed up regularly.)

If a product failure occurs within the warranty conditions then please contact FarmSense to arrange for a return to manufacturer authorisation (RMA) and instructions. A proof-of-purchase must accompany all warranty claims. The warranty liability is limited to repair, replacement or refund of the faulty product, at FarmSense's discretion.

If a product failure occurs outside of the warranty conditions, please contact FarmSense to discuss repair or replace options at FarmSense's discretion.

FarmSense, their Distributors, and their Dealers accepts no responsibility for the misuse of this product or for any accident caused by any tampering, modification or misuse of this product.

This warranty does not affect your statutory rights.

To submit a warranty claim, please visit farmsense.nz/warranty